



# BRYN MAWR BUGLE

Published by the Bryn Mawr Neighborhood Association

April 2021



## Festival of Garage Sales

The BMNA has postponed the annual Festival of Garage Sales normally held the first weekend in May. We are seeking input for possible dates to reschedule. Our first priority is safety so we will also be looking to the state for guidance.

1. Are you planning to have a Garage Sale?

\_\_\_ Yes \_\_\_ No

\_\_\_ Maybe, depends on COVID/Vaccine situation

2. Are you planning to shop the Garage Sales?

\_\_\_ Yes \_\_\_ No

\_\_\_ Maybe, depends on COVID/Vaccine situation

3. Please rank (1-14) these possible dates for Garage Sale weekend in order of preference:

\_\_\_ June 5 \_\_\_ July 17 \_\_\_ August 2

\_\_\_ June 12 \_\_\_ July 24 \_\_\_ August 2

\_\_\_ June 19 \_\_\_ July 31 \_\_\_ Sept 11

\_\_\_ June 26 \_\_\_ August 7 \_\_\_ Sept 18

\_\_\_ July 10 \_\_\_ August 14

4. Are you planning to have a sale regardless of when the BMNA reschedules?

\_\_\_ Yes

\_\_\_ No, I am going to wait for the BMNA Festival of Sales weekend

\_\_\_ Depends when the reschedule date is

\_\_\_ N/A, I'm not having a sale

5. If yes, when?

\_\_\_\_\_

\_\_\_\_\_

6. Anything else you would like us to know?

\_\_\_\_\_

\_\_\_\_\_

\_\_\_\_\_

Please return this to the BMNA box at the Bryn Mawr Market or fill it out online at [BMNA.org](http://BMNA.org).

## WinterFest 2021

And like that, it's a wrap! The third annual WinterFest could have been called SpringFest but that's March in Minnesota for ya'. There was luminary making led by the Minneapolis Nature Preschool at Bryn Mawr Elementary. The PTA was selling cocoa and coffee. Kites were flying high in the meadows. Music was played and sparklers were lit at La Mesa. Marshmallows roasting over open fires and friendly faces under masks could be found throughout the neighborhood. Thank you to our wonderful volunteers and the many businesses that donated raffle items.



Photos by Jay Peterson, Area 6



## Membership Drive

The 2021 Membership Drive is underway and you can give at [www.bmna.org](http://www.bmna.org). We love reading your comments in the envelopes that come via the mail. Here are a few that made our day.

"Thanks for the welcome to the neighborhood. We're very excited about all of the awesome events coming this year with BMNA, especially the pet photo contest this summer. Excited to meet more of our neighbors in the warmer weather."

"I have been a member since it began and delivered The Bugle about that long. Keep up the good work."

"I went to Anwatin School a WHILE ago and it's great to be back in this beautiful area with beautiful people."

*Have you joined yet?*

## Bryn Mawr Neighborhood Association Membership - 2021

The BMNA does not charge dues. Please consider making a financial contribution of \$50 or more along with your membership. *BMNA is a 501C3 tax deductible organization.*

**Yes, I want to help the BMNA by making a financial contribution of:**

\_\_\_ \$50 \_\_\_ \$75 \_\_\_ \$100 \_\_\_ Other \_\_\_\_\_

Name(s): \_\_\_\_\_

Address: \_\_\_\_\_

Phone: \_\_\_\_\_

E-mail: \_\_\_\_\_

Help us save postage by including your email address – we'll send your receipt to your inbox. If you don't have an email account, no problem, we'll still promptly mail your receipt. Check should be made payable to BMNA, For security please do not leave memberships at the Market.

**Please mail to:**

Bryn Mawr Neighborhood Association  
2915 Wayzata Blvd.  
Minneapolis, MN 55405-2145









The City launched a website that offers information and updates around the upcoming trial of former Minneapolis Police Officer Derek Chauvin, who is charged with murder in the death of George Floyd.

City information and links to partners in the new web section will help residents, businesses and others:

- Find current street closures.
- Sign up for trial updates from MN District Court.
- Report suspicious activity.
- Look up mental health and well-being resources for support during traumatic times.

You can also explore ways to prepare and stay informed, learn about security preparations and updates during the trial, follow impacts to traffic and transportation, and find public data on the officers involved.

How to contact the City:

Call 311 for non-emergency City information.  
Call 911 for life safety emergencies requiring police, fire or emergency medical services.

Call the MPD Tips Line at 612-692-TIPS (8477) to report suspicious activity not requiring an immediate response.  
Businesses and property owners can call 612-673-2499 with questions about advanced preparation before the trial, business operations during the trial and general information about regulations and resources.  
The web page will be updated as new information becomes available and as situations change. The BMNA will pass along updates as we receive them via this email list, our Facebook, Twitter, Instagram and NextDoor accounts but for the most up to date 24/7 information please refer to the city website where you can subscribe to updates.

Other Resources

The BMNA encourages you to seek out other resources for support during the trial. The December 2020 issue of the Bugle which can be read here has a list of organizations led by and supporting the BIPOC community on page 9. The Legal Rights Center is another good resource for understanding the trial and the issues surrounding it.

Charter Amendment

Community safety and police brutality have become focal points in Minneapolis and around the country in the past year especially. Several groups have started to envision what a safe community for all looks like where violence prevention is front and center. There are 3 proposals right now to restructure the Minneapolis Police Department. The city charter can be amended two ways: by an ordinance which requires the unanimous vote of the City Council and the Mayor, or by a ballot question. An amendment makes it to the ballot one of three ways: by either a citizen petition with signatures equaling 5% of the votes cast from the last election, by submission from the City Council after a non binding review by the Charter Commission, or by the Charter Commission.

The first proposal, the Public Safety Amendment, would abolish the Minneapolis Police Department as a city department, eliminate the requirement to maintain a minimum number of officers, and greatly reduce the mayor's responsibility and accountability for law enforcement. The new Minneapolis Department of Public Safety would be modeled after the MN Department of Public Safety and would report both to the Mayor and the City Council instead of the current model of reporting only to the Mayor. The Department of Law Enforcement would be one of the departments in the Department of Safety and would employ peace officers. It is a slightly revised version of the proposed amendment from last year that was sent to the Charter Commission who rejected it citing the short timeline leading up to the November 2020 elections. City Council is working on further ordinances to clarify the functions, leadership, and operations of the department. The Charter Commission is reviewing this proposed amendment and will recommend to the City Council that they move forward, reject, or replace with an alternative amendment by August. Their recommendation is not binding. It would be up to the City Council to move forward with putting it on the ballot. The Mayor would also review the proposed amendment and could veto a City Council vote which could then be overruled by a 9 vote decision at City Council.

A second proposal is being brought forth via a people's petition by a coalition group called Yes 4 Minneapolis. This campaign is made up of members such as Reclaim the Block, Black Visions, Minnesota Fed-

eration of Teachers, ACLU, Take Action MN, Pollen, Jewish Community Action, Coalition of Asian American Leaders, Little Earth and others. Their amendment would also replace the Police Department with a Department of Public Safety which would include licensed peace officers. There would not be a minimum number of peace officers required. The Department would report to a Commissioner, nominated by the Mayor and appointed by the City Council. This amendment would be on the ballot in November if it gathers enough in person signatures by May 1. Their website states that their motion was developed through a community input process and that they are working with City Council and the two proposals are not in conflict. Both proposals focus on integrating public health and safety. More information can be found at [yes4minneapolis.org](http://yes4minneapolis.org)

A third proposal would create a new Civilian Police Accountability Commission (CPAC) that takes oversight of the police department away from the Mayor. This effort is being led by the Twin Cities Coalition for Justice 4 Jamar. The CPAC would be made up of 13 elected members elected for 4 year terms and who have experience serving and advocating for those most impacted by police crimes. This amendment would be on the ballot in November if it gathers enough in person signatures by May 1. More information can be found on their website [sites.google.com/view/tcc4j/home](https://sites.google.com/view/tcc4j/home)

The Charter Commission is also considering a change of its own, not to the Police Department but to the leadership structure of the city that would restructure the relationship between the Mayor and the City Council. One option would give the Mayor more power and better define the role of City Council. Another would create a position of City Manager as a go between the Mayor and the Council. Another option is to clarify the duties and responsibilities of city government. These changes being discussed do not alter the Police Department.

Stay tuned for more updates and learn more about these important issues on your own. The issue will likely be part of the upcoming City Council election, and you may want to ask the candidates what they think about the options. The League of Women Voters recently hosted a talk on the city charter and the proposed amendments. A recording can be found at [lwvmpls.org/category/civic-buzz/](http://lwvmpls.org/category/civic-buzz/)

Edina Realty

a Berkshire Hathaway affiliate

Julie Munnich

612.986.0681 Call/Text

JulieMunnich.com

JulieMunnich@edinarealty.com

311

Call

Minneapolis

Call Minneapolis 311 for information

Weekdays 7 AM to 7 PM

Weekends 8 AM to 4:30 PM

Minneapolis 311 is also a 24-hour online resource for access to City services.

Minneapolis311@minneapolismn.gov

Rolayne's Hair Design

408 Cedar Lake Road

612.377.4179

Hair cuts, color, style and product.

Appointments & walk-ins welcome!

Juliette

Paul Mitchell products

Nancy

Neuma organic hair products





# Recycling

www.ci.minneapolismn.gov/  
solid-waste  
(612) 673-2917

## Bryn Mawr Recycling Schedule

	Monday	Tuesday
Area 1	April 5 April 19	
Areas 4W, 5W, 6, 7	April 12 April 26	
Areas 2, 3, 4E, 5E		April 13 April 27

Use it up, wear it out, make it do, do without. Recycle.

What are you doing this weekend? Why not go DANCING!  
**LIVE music is more FUN!**



www.percolatorsband.com

Check our website & come see us. We'll rock your socks off!  
Hans Gasterland, drums. Call today: **612-723-5038**



# Bryn Mawr Soap

On sale at Bryn Mawr Market  
and Twin Cities area co-ops

www.brynmawrsoap.com      612-374-3613



# JIM TOLLEFSRUD

PIANO TUNING & REPAIR

16121 377-8345      608 South Cedar Lake Road  
Minneapolis, Minnesota 55405



# MILL CITY DENTAL

JAY WILLIAMS, D.D.S.

612-377-3740

2218 LAUREL AVENUE • MINNEAPOLIS, MN 55405

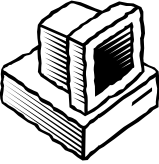

# From the Editor

After spending so much time at home alone, I have sadly become one of those people who yells at the TV. Tonight, I was yelling at the Hill Murray hockey dad talking about how unfair it is that their team had to drop out of the state hockey tournament because of a Covid exposure. Instead of being grateful for having a season at all (when performing arts student had to completely give up theirs) they were mad because they had to follow the rules they agreed to at the start of the season.

But the rules are slowly adapting to new circumstances. I am happy to report that I have both doses of the vaccine on board and am forging ahead with plan a for a robust in-person summer youth program. We are projecting that it will be safe by June to be in small groups outside and we are even planning a musical that hopefully will be performed for a live audience.

The anniversary of the shutdown passed. We look back and recall thinking it would last a week or maybe a month. Many have died, had life altering disruption and/or financial disaster. I've missed live theatre, dining in restaurants and hugs (oh how I have missed hugs.) If I had a kid playing hockey, I would miss that too. But they all seem like petty inconveniences compared with all the loss that others have endured.

The true reality check came this past week as I watched in horror the testimony of the witnesses to the death of George Floyd at the hands of Derek Chauvin. I am so fortunate to have never seen anything like this and am completely devastated just by watching and listening to the video recordings. I wonder what I would have done had I been at the scene as Mr. Floyd lay dying and crying out for help. Would I have felt anger? Fear at the sight of a police officer being so dispassionate? To hear that an off-duty first responder recognized that immediate medical attention was needed and was dismissed is mind boggling. To hear children and adults express guilt that their efforts could not save his life absolutely breaks my heart.

I cannot believe it. I cannot believe it because it would never happen to me. I have never had reason to fear the police and the sad reality is that black, indigenous and people of color are all to familiar with seeing their people being treated as less than human.

After all we have been through together, I hope that we emerge from this pandemic wiser, more empathetic and more willing to see our common humanity.

- JoEllyn Jolstad, editor@bmna.org

# NORTH END HARDWARE



## Exceptional Service

### Have a job? We have a Tool.



## Northend Rental Just Rent It!

### NORTH END HARDWARE & RENTAL

at PENN and LOWRY

Hours: M-F, 7 a.m.-6:30 p.m.; Sat, 7 a.m.-5 p.m.

Darryl Weivoda, Owner

612-529-9151 • Northendhdwr@aol.com



# Update: 2800 Wayzata Blvd Development

The property most of us know as the CenturyLink Building at 2800 Wayzata Blvd will become a campus of rental apartments and townhomes. On the west side of the property, Lupe Development will deliver 100 units of affordable one or two bedroom senior apartments in a six-story building (The Theodore) and 100 units of market-rate senior apartments (The Eloise) in another six-story building. See Photo 1.

Swervo Development updated their development plans at the March 10th BMNA Board Meeting. The CenturyLink building will be rehabbed into a six-story apartment building. Two stories will be added to allow for about 120 rental units, mostly studios and one-bedroom apartments. See Photo 2. The sixth story (slightly visible) will contain amenities shared by the building. While the senior apartments will share underground parking, the CenturyLink apartment building and townhomes will have surface parking.

Swervo will also move forward with plans to build 60 townhomes for rent, mostly on the perimeter of the eastern side of property. See Photo 3. The townhomes will be in groups of 6, 8 and 10 in seven buildings set back from property lines by 20 or 30 feet. Each townhome will be 3 stories, 3 bedrooms and 2.5 baths. All of the units will have a rear door at ground level with a small porch and surface parking in front. An initial design was presented. See Photo 4. Landscaping for the entire property will be designed to create a high-end feel that will be attractive to renters. Efforts will be made to preserve as many of the existing trees as possible. A natural landscape buffer along the Upton Ave S property lines will be added for privacy. A walking path along the Upton property line will connect to the trail off of Mt. View leading into Wirth Woods.

Both Swervo and Lupe properties will be managed by a property management company. Construction is planned to begin this summer. Efforts will be made to coordinate all construction to minimize disruption to the neighborhood. A new traffic study will be done to reflect the impact of the townhomes.

Neighbors on the 600 block of Upton Ave S most impacted by the development provided written feedback to Swervo Development and the BMNA on March 16. Kevin Thompson, President of the BMNA, and Lisa Goodman, Ward 7 City Council Member, met with the developers on March 18 to discuss the plans and make recommendations. Swervo is improving on the design after neighborhood input. The BMNA looks forward to continued discussion. Everyone is welcome to attend BMNA Board Meetings on the second Wednesday of each month to follow developments. Check the agenda published on Monday or Tuesday before the meeting in the BMNA Coordinator's email newsletter and on NextDoor, Facebook and Twitter.

- Rod Miller, Area 6 Co-rep

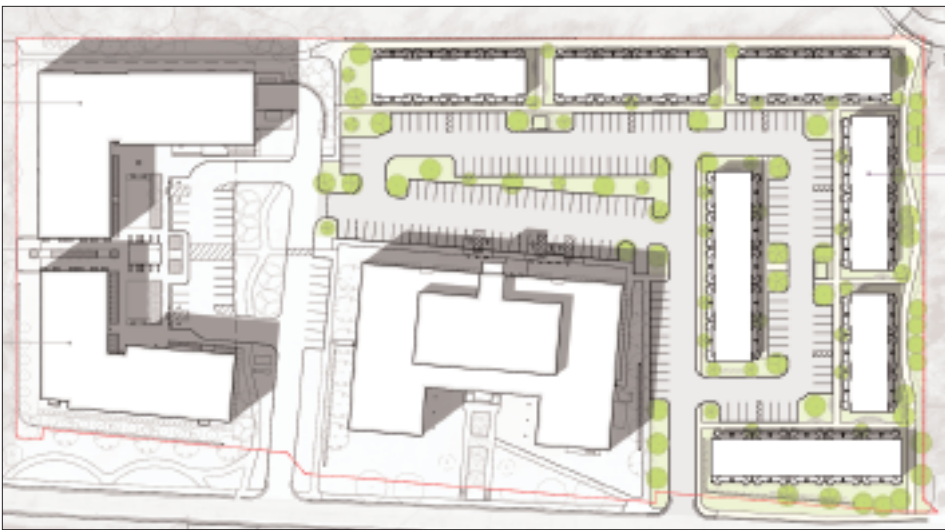



ELIZABETH SHAFFER

FOR PARK BOARD • DISTRICT 4

elizabethforparks.org

Prepared and paid for by the Campaign for Elizabeth Shaffer • P.O. Box 3744, Minneapolis, MN 55403.



1200 Glenwood Ave. N.  
Minneapolis, MN  
612-377-4900  
Family Owned  
www.northwesterntire.net

SPRING CAR CARE PACKAGE

\$49<sup>95</sup>

COUPON

Most vehicles. Must present coupon. Cannot be combined with other offers. Plus tax, shop supplies & environmental fees. Expires 5/1/21.

OIL CHANGE

\$19<sup>95</sup>

COUPON

Most vehicles. Must present coupon. Cannot be combined with other offers. Plus tax, shop supplies & environmental fees. Expires 5/1/21.

Service Special

\$10<sup>00</sup> OFF Any Service Over \$100

\$20<sup>00</sup> OFF Any Service Over \$200

\$50<sup>00</sup> OFF Any Service Over \$500

COUPON

Most vehicles. Must present coupon. Cannot be combined with other offers. Plus tax, shop supplies & environmental fees. Expires 5/1/21.

ALIGNMENT

\$20 off

COUPON

Most vehicles. Must present coupon. Cannot be combined with other offers. Plus tax, shop supplies & environmental fees. Expires 5/1/21.

We Repair All Vehicle Types

We Repair ALL Flats

Stop in for a FREE estimate



# *Time to get out of the house! (literally and figuratively)*



*Time to start getting back to normal. We look forward to helping our friends and neighbors with their real estate needs.*



*We are committed to the city and to the neighborhood we live in.*



**Annie Child & Susan Stryker**  
**[www.SUSANandANNIE.com](http://www.SUSANandANNIE.com)**

**612-819-8785 612-839-6360**

[www.SUSANandANNIE.com](http://www.SUSANandANNIE.com)







# Racial Covenants in Bryn Mawr

Beginning in the early 20th century racially restrictive covenants were recorded by developers and property owners in a home's legal title. They prohibited Black, Indigenous, People of Color and, in some cases, Jewish people from purchasing, renting and/or residing on a property. As a result of these covenants, BIPOC communities were forced to live in segregated areas of Minneapolis that have historically, and currently, had more environmental hazards, less parks and green space, less access to hospitals and health care, fewer grocery stores, and under funded schools. In 1968 Congress passed the Fair Housing Act making these covenants illegal, however they still exist on the deed record. There are approximately 70 properties in the Bryn Mawr neighborhood with racial covenants in the deeds. Although these covenants are no longer enforceable their impact still shapes the composition of the city, making it one of the most segregated in the nation.

Homeownership is one of the greatest ways to accrue and inherit

wealth, however disparities in housing and homeownership serve to further the racial wealth gap and segregation. When equal housing opportunities are denied so are opportunities to create generational wealth. A 2020 study conducted by Redfin, a real estate brokerage, finds that only 25% of Black families in Minneapolis own their home, the lowest among all metro areas in the U.S. [www.redfin.com/news/black-homeownership-rate-across-united-states/](http://www.redfin.com/news/black-homeownership-rate-across-united-states/). This disparity is largely due to Minneapolis's history of racial covenants.

The good news is that there are organizations addressing this form of systemic racism head on: Mapping Prejudice ([mappingprejudice.org](http://mappingprejudice.org)) has joined up with Just Deeds ([minneapolismn.gov/government/departments/attorney/just-deeds/](http://minneapolismn.gov/government/departments/attorney/just-deeds/)) to provide homeowners with free assistance in having these covenants discharged. We strongly encourage all Bryn Mawr residents to explore these resources and to take this opportunity to remove any racially restrictive covenants that may exist on your property. We also urge you to share this information with other Minneapolis residents. If you are looking for more ways to get involved with this project, Mapping Prejudice is still in need of volunteers to read through deeds in neighboring counties. You can find more information on their website.

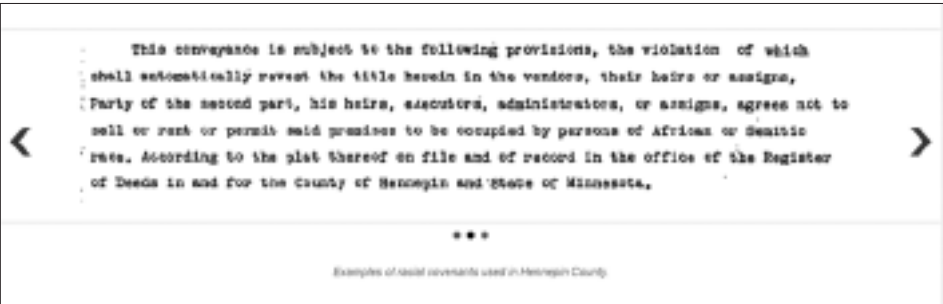
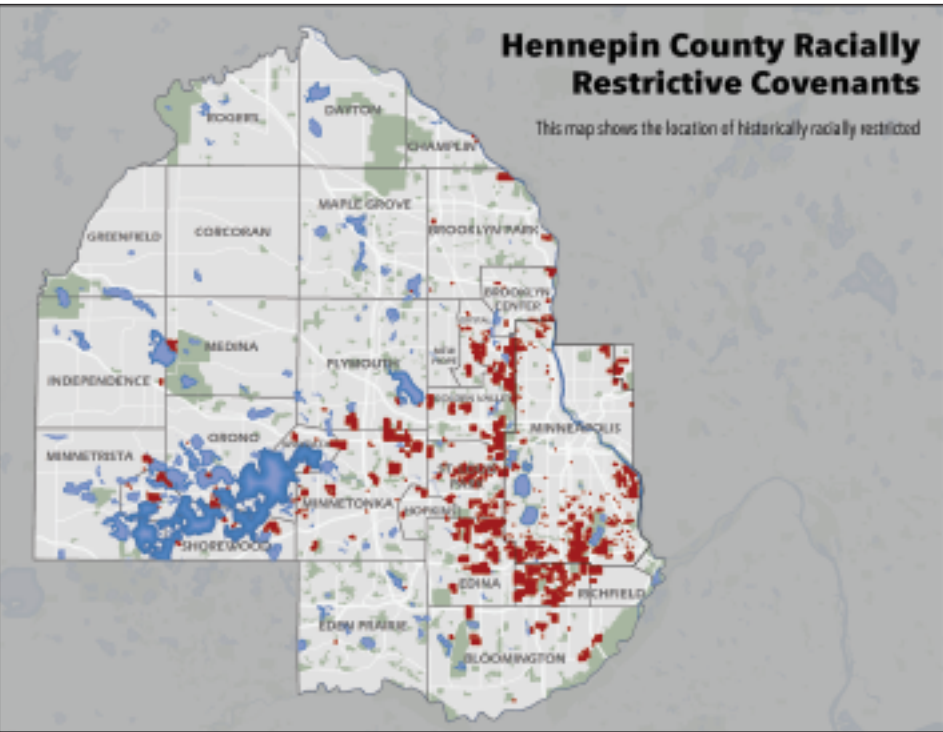

Some may be wondering why is it important to have these covenants discharged if they are no longer enforceable. Not only is it necessary to understand who has directly and indirectly benefited from these historically racist practices, but also how such practices have shaped access to real estate, which largely impacts access to wealth, health and

education. As a majority white neighborhood we have the opportunity to take action by removing these vestiges of our racist history so that future homeowners do not have to take on this burden. If you are seeking ways in which to take direct action in dismantling systemic racism, this is an excellent first step.

- Lynda Shabeen, Area 2

## Bryn Mawr Neighborhood Association Calendar - April 2021

All meetings are open - everyone is welcome. Neighbors are urged to attend and participate in meetings and activities of special interest to them. Bryn Mawr Neighborhood Association and its committees are meeting virtually over Google Meet. Email [secretary@bmna.org](mailto:secretary@bmna.org) for meeting links.

Sunday	Monday	Tuesday	Wednesday	Thursday	Friday	Saturday
				1	2	3
4	Minneapolis Public Schools Spring Break April 5-9	6	7	8	9	10
11	12	13	BMNA Monthly Meeting, 6:30pm on Google Meet. Email <a href="mailto:secretary@bmna.org">secretary@bmna.org</a> for meeting link.	Racial Justice Committee Meeting	16	17
18	19	Submissions due for April Bugle. Drop in the Bugle Box at Bryn Mawr Market or email <a href="mailto:bugle@bmna.org">bugle@bmna.org</a>	21	Earth Day	23	24
25	26	27	28	29	30	



# Help Wanted



## Area 1 Bugle Distributor Needed

Responsibilities include taking delivery of all Area 1 Bugles once a month and getting them to block distributors who circulate to neighbors. If you're interested, email [bugle@bmna.org](mailto:bugle@bmna.org).

### Thank you Mary Duffy!

A big thank you to Mary Duffy of Area 1. Mary, and more recently her daughter Nanc, have delivered The Bugle in Area 1 for over 20 years! We thank Mary for her service!



April 7, 2015    Loon calling on Cedar Lake, resting and feeding before heading “up north”.

April 13, 2020    Migrating horned grebes on Bde Maka Ska, on their way to Lake Winnipeg for the summer. Smallish duck-like birds with a distinct golden triangle on each side of their head. April is a good time to visit a lake or river and look for migrating waterfowl.

April 14, 2014    Many red winged blackbirds near Wirth Lake. Like swallows, males arrive about two weeks before females.

April 19, 2016    Great blue heron fishing in Bassett’s Creek near the “Tornado Alley” trail in Wirth Park. Although many migratory birds’ spring arrival in Minnesota varies depending on weather and ice-out, these guys show up on March 14 every year, give or take a day.

April 26, 2020    Full moon, the Ojibwe maple sugar moon.

# FURTHER

performance

VW • AUDI • EURO • CLASSIC

MAINTENANCE

RESTORATION

PERFORMANCE

NEW LOCATION

305 THOMAS AVEN., MINNEAPOLIS

612-374-2604

FPTUNED.COM



# Parks

[www.minneapolisparcs.org](http://www.minneapolisparcs.org)

## Eloise Butler Wildflower Garden

Eloise Butler Wildflower Garden and Bird Sanctuary reopens April 15. The Garden will be open Tuesdays through Sundays 10 am to 6 pm and Thursdays 8 am to 8 pm. Eloise Butler is closed on Mondays. All visitors will follow a one-way route through the Garden to allow for social distancing on narrow trails. Please bring a face covering to wear at times when it may be difficult to maintain social distancing. Enjoy a leisurely, semi-secluded visit: Entry for groups and individuals is staggered every few minutes. More details at MPRB’s Eloise Butler Wildflower Garden and Bird Sanctuary web page.

### Earth Day

Join MPRB as we carry on the annual Earth Day cleanup – in DIY mode!

You can participate anytime in April– while staying safe and preventing the spread of COVID-19.

By sharing photos of your cleanup, everyone will see what we can accomplish #alonetogether for the 2021 Earth Day.

#### Your DIY Earth Day Cleanup:

Use a trash bag from home or check the Parks website to find a site near you to pick up supplies

Head to a nearby park or trail and pick up trash you see, while getting fresh air and exercise!

Practice social distancing and other current COVID-19 guidelines. Learn more at [minneapolisparcs.org](http://minneapolisparcs.org) Share pictures your trash haul on Facebook – at @MPLSEarthDay – use hash tag #mplsDIYEathDay

## New Bike Skills Park

There is a new bike skills park at the Bryn Mawr Meadows. It is a bit more advanced than the other skills parks in town. The features are taller, there is a teeter totter and a small drop. The skills park is located on the tennis courts. The tennis courts are scheduled to be removed in the upcoming renovations. More information can be found on the Park Board website.



# Minneapolis Property Owners Can Buy a \$25 Tree this Spring

Minneapolis property owners will soon be able to order a 5- to 8-foot tree for \$25 each to plant on their private property. The 2,000 trees in 24 varieties this year include large and medium shade trees, fruit trees, evergreens and smaller flowering trees. Comparable trees cost about \$125 at a nursery.

Purchasing will close April 16 or when the trees run out, whichever is first.

Low-cost trees are available first-come, first-served.

People will need to pick up their tree May 15, 16 or 17 (subject to change). Location is to be determined and will be emailed to people who bought a tree. Volunteers onsite will help load each new tree

and a complimentary bag of mulch into vehicles on request.

People can find more information and order their tree through Tree Trust website <https://treetrust.org>.

## Garden Workshops

Ready to spend more time in your yard? Do you want to improve it but don’t know where to start? Learn with experts to plan and create beautiful, functional spaces that also protect the local ecosystem whether you want a rain-garden and native prairie, or a low-maintenance lawn that also helps pollinators.

Online presentations in landscape design, pollinator habitat, soil health, native plants and yard maintenance will be hosted by Blue Thumb landscape designers and UMN Extension Master Gardener volunteers – Hennepin County.

Scholarships are available on request. Space is limited. For more information and to register, go to [bluethumb.org/events](http://bluethumb.org/events) or call 651-699-2426.

# Be part of the Bugle!

BUGLE NOTES • FASCINATING FOLKS • PHOTO FEATURE

• OUT & ABOUT • UNSUNG HEROES • YOUTH & SCHOOLS •

PARKS • ENVIRONMENT • GARDENS

Email your neighbor news and photos to [bugle@bmna.org](mailto:bugle@bmna.org).



## PTA 2021 Plant Sale

### Bryn Mawr Elementary School

This is our biggest fundraiser of the year. Your order helps provide additional programs to students at Bryn Mawr Elementary School.

What makes our sale special?

**High Quality Locally Grown Plants**-You will marvel at these beautiful, high quality, full-size, healthy plants grown by Glacial Ridges Growers in Glenwood, MN. "We use **NO insecticides, NO herbicides, NO growth retardants, and NO genetically modified seeds.**"

**"NO NICS" – BEE AND BUTTERFLY FRIENDLY** "Glacial Ridge is committed to production methods friendly to bees and butterflies. We use NO neonicotinoids in our greenhouse operation. We have also painstakingly researched our suppliers to get their assurance that they use no "neonics". In addition, we offer the most extensive selection of pollinator plants available." "RESTORING THE NATIVE PRAIRIE ONE BACKYARD AT A TIME." Pollinators are marked with a **B**.

**Unique Selection** - This is no ordinary plant sale! We have the garden basics as well as some unusual cultivars including seedling perennials, heirloom tomatoes, rain garden plants, and patio vegetables. Even if you are a loyal supporter of another plant sale, with 135+ varieties, we know you will find something you like! To see photos of all the plants and/or order online, go to <https://sites.google.com/site/brynmawrcommunityschool/plant-sale>

**How to Order by April 22<sup>nd</sup>, 2021:**

1. Enter # of plants and then circle the # and name of each plant ordered. Scan or take a photo of your form to keep for your records. Or order online (see below)! Would you like a full flat or something not offered? Email us at [ptabrynmawrmn@gmail.com](mailto:ptabrynmawrmn@gmail.com) to see if we can get it for you.
2. Send completed Order Form, with full payment, to Bryn Mawr Community School, 252 Upton Avenue S, Minneapolis MN 55405. Make checks out to Bryn Mawr PTA. Thanks for supporting Bryn Mawr Community School! **Orders must be received by Thursday, April 22, 2021.**
3. Pick up your plants outside school on May 6<sup>th</sup>, 2021 **between 3:30 and 6:30.** There will be an "Overstock" section for last minute, on-the-spot plant purchases. Remaining plants will be sold at the "Last Chance Sale" in downtown Bryn Mawr, corner of Cedar Lake Road & Laurel Ave on Friday and Saturday (if necessary).
4. Or, you can order online by April 22nd, at <https://sites.google.com/site/brynmawrcommunityschool/plant-sale>. Scan here to go to the web page. Pickup same as above.

Native Perennials and Wildflowers

3-inch pots for \$3.50 each.

Rain Garden Appropriate!

- SHADE
- #1 Sweet Joe Pye Weed (Eupatorium purpureum), Large leaves in whorls around the stem and attracts swallowtail butterflies. Native wildflower, shade to part sun **B**

#2 Cranesbill (Geranium pratense), Clear violet blue flowers on foliage that looks great all season, shade to full sun

#3 Cardinal flower, (Lobelia cardinalis) Hardy native green foliage, spectacular deep red show in midsummer, shade to part sun **B** (hummingbirds)
- NEW in 2021
- SUN

#4 Spotted Bee Balm, (Monarda punctata) Pastel pink bracts on strong stems, mildew resistant, part shade to full sun **B**

#5 Columbine (aquilegia canadensis). Drooping, bell-like 1-2" red and yellow flowers. Resistant to leaf miner. Sun to part shade **B**

#6 Showy Milkweed (Asclepias speciosa), 4-5" clusters of pinkish/purple fragrant blooms, Native wildflower, sun **B**

#7 Gay Butterflies (Asclepias tuberosa), Clusters of yellow, orange and red flowers, Native wildflower, sun **B**

#8 New England Aster, (Aster novae angliae) Large and showy, bright rose-purple flowers with orange-yellow centers bloom in profusion at the tips of the leafy branches, Native wildflower, partial shade to sun **B**

#9 Mistflower (Eupatorium coelestinum) Grows to 3 ft high but often lower, with leaves opposite somewhat triangular in shape, and bluntly toothed. **Attracts bees and butterflies.**, Native wildflower, partial shade to Sun **B**

#10 Meadow Blazing Star Liatris (Liatris ligulistylis) Brilliant purple flowers in late summer, attracts birds and butterflies, Native wildflower, partial shade to sun **B**

#11 Cup Plant (Silphium perfoliatum) Big leaves catch dew, attracts butterflies and hummingbirds, 3" daisies, square stems, imposing rear border plant, Native wildflower, partial shade to sun **B**

#12 Cerise Queen Yarrow (Achillea millefolium) Long blooming rose color cottage garden plant with feathery foliage that is great for garden plant or for cut flower, 24", partial shade to sun **B**

- #13 Purple Butterfly (Buddleia davidii) Deep violet purple color for a butterfly garden, 48" sun **B**

#14 Dianthus Indian Carpet Midget Mix (Dainthus barbatus) Sweet William, big flowers, blooms first season, sun **B**

#15 Purple Coneflower (Echinacea purpurea) Native wildflower species, big flowered coneflower with drooping raspberry petals, sun **B**

#16 Rudbeckia Goldstrum (Rudbeckia fulgida) Black eyed Susan, long blooming, yellow with brown centers, hardiest, spreading, sun **B**

#17 Scabiosa Perfecta Clear Blue Pincushion (Scabiosa caucasica) Large blue flower, sun **B**

#18 Sedum Dragon's Blood (Sedum spurium coccineum) Bronze foliage, covered with blood red flowers in summer, hardy ground cover for sun **B**

#19 Hardy Hens and Chicks (Sempervivum tectorum) Succulent rosettes, evergreen, multi colored foliage for rocks in any soil 5" sun

#20 Aster – Lanceleaf Coreopsis (coreopsis lanceolata) Yellow, daisy-like flowers atop 12-30" stems. Deadhead to extend blooming. Sun to shade **B**

Native Perennial Grasses & Sedges

3-inch pots for \$4 each.

- #21 Canada Wild Rye (Elymus canadensis) Clumper, fast grower, versatile, blue green leaf, use flowers in fresh or dried arrangements, partial shade to sun

#22 Sweet Grass (Hierochloe odorata) Spreading green leaf, panicles of sweetly scented green spikelets, partial shade to sun

#23 Indian Grass (Sorghastrum nutans) Beautiful tan feathery plumes, butterfly attractor, tolerates poor soil, gray green leaf turning orange in fall, partial shade to sun

#24 Curly Wood Sedge (Carex rosea) Very narrow, fine leaves, slight rose tint to seedheads. Drought tolerant and deer repelling. 2-5' ht, 3-4' spread. Shade to sun

#25 Fringed Sedge (Carex crinita) Ornamental tufted sedge with shiny evergreen leaves. Pest resistant, deer repelling. 1' ht, 1' spread. Shade to sun

Annuals

4-plant pack - \$2.50

12 pack flat (48 plants) - \$25

- Alyssum - This lovely edging plant blossoms early with masses of tiny flowers on 4-6 inch high plants. It will spread approximately 9 inches over the summer, and continue to blossom if you shear it back a bit mid-season. Sun

# 26 Wonderland Deep Purple

# 27 Wonderland White
- Begonias - These versatile annuals will bloom all summer in heavy shade or in sun (if kept watered and somewhat shaded mid-day). They are 10 inches tall with an equal spread. Classic glossy bronze leaves.

# 28 Cocktail Gin Pink

# 29 Cocktail Vodka Red

# 30 Cocktail Whiskey White
- NEW varieties in 2021
- #31 Celosia Castle Mix Scarlet and yellow Plumosa dwarf (8"), heat and drought tolerant, excellent garden performer, sun

#32 Boy Blue Bachelor Buttons (Centaurea) – Cheerful pom-pom blooms. Excellent in bed or as cut flowers. 36" tall, sun to part shade.
- Coleus - Colorful foliage for sun or shade.

#33 Fairway Mix

#34 Wizard Sunset

#35 Black Dragon
- NEW varieties in 2021
- Cosmos – Lots of large, 4-6 inch flowers with petals in violet, pink and white and delicate, feathery foliage. Excellent 12 inch high compact variety, good for cut flowers. Mostly sun

#36 Cosmic Mix

#37 Seashells Mix
- #38 Dianthus Ideal Mix–Continuous blooming, heat tolerant, compact hardy, 10" Sun

#39 Dusty Miller Silverdust This beautiful silver plant is grown for its foliage. It does best in full sun but also will tolerate some shade. It is frost tolerant and will keep its attractive appearance into Fall.
- Gomphrena Mostly Sun. Excellent border plant or cut flower, long and strong stems, everlasting. 24"

#40 QIS Purple

#41 Strawberry Fields

Annuals

4-plant pack - \$2.50

12 pack flat (48 plants) - \$25

- Impatiens - Very popular, shade tolerant bedding plant. Also does well in pots (8")

#42 Accent Burgundy

#43 Accent Lavender

#44 Beacon Bright Red

#45 Beacon Salmon

#46 Beacon White

#47 Beacon Select Mix
- #48 Lobelia Regatta Marine Blue - Beautiful, cool blues in the heat of Summer. Mostly Shade
- Marigold – These garden favorites get 8-12" high. Mostly sun. Try planting them with vegetables to keep pests away.

#49 Safari Mix French dwarf 4" double flower mix of gold, orange, primrose, red, tangerine, yellow.

#50 Strawberry Blond Pastel pink, rose and yellow. NEW in 2021

#51 Mr. Majestic Bold red and yellow.
- Pansy - Here is a frost tolerant plant to get you into the gardening spirit in early Spring. Pinch off spent flowers to promote more blooms. Mostly sun.

#52 Black Devil. 3" coal black flowers, a real standout.

#53 Imperial Antique Shades, Large flower mix of apricot, primrose, white, rose

#54 Magnum Blue Blotch, Large flowers, best of all season performance, blue
- Petunia - We offer a few varieties of this popular sun-loving annual. Carpet Series 10" multiflora with 2 1/2"blooms:

#55 Carpet Blue

#56 Carpet Pink

#57 Prism Sunshine (lemon yellow)

#58 Espresso Frappe Rose (deep pink with frilled edges)

#59 Picobella Mix (tiny 1" flowers)
- NEW varieties in 2021
- #60 Portulaca Sundial Mix - Moss Rose, A low growing relative of the cactus family, It is heat and drought tolerant. Needs full sun to bloom. Hot pink, salmon, yellow and white.

- Salvia - This one is heat and drought tolerant and will produce an abundance of flowers from early summer to late autumn. Mostly sun

#61 Victoria Blue (21" Farinacea type)

#62 Rambo Red
- #63 Snapdragon Sonnet Mix – 20" - These fun flowers are a favorite with children. Frost tolerant. Mostly sun

#64 Torenia Clown Mix (blue, rose & white) - (Wishbone Flower) - Shade gardeners this one is for you! It grows to 8" and loves heat and humidity. Full to part shade.
- #65 Vinca Cooler Peppermint (white w/ red) – (Periwinkle) Good in sun or half sun. Color from the heat of midsummer into autumn. It has phlox like blooms and beautiful glossy green leaves. 10-12" high.

#66 Viola Sorbet Lemon Chiffon – (Johnny Jump Up) Upper petals are light yellow deepening to gold, mostly sun.
- #67 Zinnia Profusion mix (12 inch) - Colorfast and virtually disease proof, blooms prolifically through the summer heat, mostly sun.

Jumbo Annuals

3-inch pots for \$4 each

- #68 Dahlia Harlequin Mix – Bi-colored, semi-double, wide range of colors, early.

#69 Morning Glory - Popular climbing vine with bell-shaped flowers. Heavenly Blue
- Wave Petunia - Cascading sun-lover, spreading

#70 Easy Wave Red

#71 Pink

#72 Purple
- #73 Bacopa - Trailing deep-green plant covered with tiny white flowers
- Tuberous Begonia - Reliable, showy double flowers with dark green semi-succulent leaves. Part shade to part sun

#74 Orange

#75 Rose Pink

#76 Yellow
- NEW color '21

More plants on other side of this page



PTA Plant Sale Order Form Continued from other side.



Premium Annuals  
4-inch pots for \$5 each

- Geranium, cutting grown - Great for pots or garden.
- #77 Hot Pink
  - #78 Red
  - #79 White
- #80 Nasturtium – Golden King. Prolific bloomer with edible flowers and leaves. Single gold flower. Full to part sun. Height 1-2 ft.
- #81 New Guinea Impatiens - Dramatic flowers with glossy dark green leaves. Grow in sun or shade. Petticoat Red Star
- #82 Purple Fountain Grass – Impressive accent plant, arching foliage, attractive seed heads. Height 3-5 ft.

Annual Greenery  
These plants add interest and maintain foliage in your planters or beds throughout the summer. 4-inch pots for \$4 each.

- #83 Eucalyptus - Baby Blue
- #84 Spikes
- #85 Sweet Potato Vine - Blackie
- #86 Sweet Potato Vine - Lime
- #87 Vinca Vine traditional green

Complete both sides of this form and return it with payment to Bryn Mawr School by April 22 or use this as a guide and order online:



Hanging Baskets  
10-inch beauties only \$25 each.

- #88 Bacopa, dark green leaves with a profusion of tiny white flowers. Sun to pt shade
- #89 Calibrochoa, Aloha Kona (hot orange). Sun to part shade
- #90 Coleus Cascade Red- Full shade to partial sun.
- #91 Fuschia Rose & Violet - Shade to partial sun
- #92 Impatiens, Double – Musica Fine Purple (burgundy) Shade to partial sun
- #93 Impatiens, Double – Musica Pink Aroma (rosy pink) Shade to partial sun
- #94 Lobelia, Fountain Crimson
- #95 Snapdragon, Candy Showers Cascading Red Full sun
- #96 Tuberous Begonia Orange, popular for their large flowers which bloom all summer. Part shade to part sun
- #97 Tuberous Begonia Red Vermillion, popular for their large flowers which bloom all summer. Part shade to part sun
- #98 Tuberous Begonia Yellow Blitz, popular for their large flowers which bloom all summer. Part shade to part sun
- #99 Wave Petunia - Pink, large spreading. Full to partial sun
- #100 Blueberry Lime Jam Petunia Mix of lime green and deep purple petunias, Sun
- #101 Dazzler. Mix of red and blue verberna, bright yellow bidens, Sun
- #102 Fireworks. Mix of red, purple, yellow calibrchoa, Sun
- #103 Glitz, Mix of Euphorbia with blue browalia, Shade
- #104 Hot Toucan Mix. Mix of hot toucan purslane. Sun
- #105 Misty Showers. Mix of blue lobelia and red/white fuchsia. Shade
- #106 Raging Fire, Mix of yellow, orange and red calibrochoa
- #107 Rainbow Cascade. Mix of rainbow coleus, white and blue lobelia, Shade

Herbs - Kitchen Garden  
3-inch pot for \$2.50

- #108 Arugula, Rocket
- #109 Basil, Sweet Eleanora
- #110 Cilantro (Coriander)
- #111 Dill, Bouquet
- #112 Lavender, Lady
- #113 Mint
- #114 Oregano, Greek
- #115 Parsley, Crispum plain
- #116 Rosemary
- #117 Sage, Garden
- #118 Thyme, English

Strawberry  
4-plant pack - \$3

- #119 Everbearing, Ozark Beauty

Patio (compact) Vegetables  
3 inch pot for \$2.50

- #120 Cucumbers, Patio Snacker Short, vining, early continuous yield 8" crunchers!
- #121 Eggplant Bambino - Miniature, 1' dark beauties in clusters for shish-ka-bob! 12" tall.
- #122 Pepper Pretty 'n Sweet - Mildly sweet, mini yellow, orange & red peppers. High-yield! 12" w by 12-24" high.
- #123 Tomato Sweet 'n Neat, Cherry Red Extra compact, grow in a window! Masses of cherry-sized fruit on a strong upright plant.

Vegetables  
3 inch pot for \$2.50

- #124 Cucumber, Pickling - Medium green, slightly tapered, black spines
- #125 Eggplant, Turkish orange, unique brilliant orange, green stripes, tennis ball size, very flavorful, great stuffed!
- #126 Pepper, Hot Jalapeño, green to red, early ripener
- #127 Pepper, Sweet Red Knight, blocky, early red
- #128 Pepper, Heirloom Sweet King of the North, pick green to red, 60-70 days, large

Heirloom Tomatoes  
3 inch pot for \$2.50

- #129 Amish Paste (large roma-shaped, fleshy. Fresh sweet-meets-tangy flavor!)
- #130 Brandywine (luscious flavor, rich, loud, spicy, large fruits, often over one pound!)
- #131 Cherokee Purple Burgundy fruit, large 12 ounce, unique and tasty
- #132 Goddess Isis Candy Cherry Red, marbled, cats eye starburst at blossom end, sweet fruity taste
- #133 Moskovich (Early-ripener! Deep red, round fruit with rich taste.)
- #134 San Marzano Thick red flesh, few seeds. Perfect for Caprese salad or canning!
- #135 Striped German (large beefsteak-type red & yellow fruits, often over one pound!)
- #136 Valencia (meaty medium-sized yellow-orange fruits, balanced flavor.)

MN Horticultural Society Pollinator Paks

MN Hort Society gets a donation for every Pak sold. Each pak has 6 pollinator-friendly plants. \$20 per Pak. Limited Supply! Max of one of each type per household, please.

- #137 Bee Mix: Agastache foeniculum-Anise Hyssop; Baptisia australis-Blue Wild Indigo; Clematis recta-Vanilla Scented Clematis; Geum triflorum-Prairie Smoke; Penstemon digitalis-Foxglove Beardtongue; Ruellia humilis-Wild Petunia
- #138 Butterfly Mix: Echinacea pallida-Pale Purple Coneflower; Liatris aspera-Button Blazing Star; Liatris ligulistylis-Meadow Blazing Star; Liatris pycnostachya-Prairie Blazing Star; Lupinus perennis-Wild Lupine; Rudbeckia fulgida-Orange Coneflower
- #139 Monarch Mix: Asclepias incarnata-Swamp Milkweed; Asclepias speciosa-Showy Milkweed; Asclepias sullivanti-Sullivan's Milkweed; Asclepias syriaca-Common Milkweed; Asclepias tuberosa-Butterfly Weed; Asclepias verticillata-Whorled Milkweed

Orders DUE APRIL 22nd

Name: \_\_\_\_\_

E-mail: \_\_\_\_\_

Phone #: \_\_\_\_\_ Total Amount Due: \$ \_\_\_\_\_

Total # of Plants: \_\_\_\_\_

Orders with full payment (checks made out to **Bryn Mawr PTA**) can be mailed to or dropped off at Bryn Mawr School, 252 Upton Ave S, Minneapolis, MN 55405. Thank you for supporting our community school!

ORDERS DUE APRIL 22<sup>nd</sup>

Pick up orders at school Thurs, May 6<sup>th</sup> 3:30-6:30 PM.  
Email [ptabrynmawrmn@gmail.com](mailto:ptabrynmawrmn@gmail.com) with questions.



Learn More About Our Community Schools

**Bryn Mawr Community School (PreK-5)**  
[brynmawr.mpls.k12.mn.us](http://brynmawr.mpls.k12.mn.us)  
Call 612-668-2500 to arrange a tour.

**Anwatin Middle School (6-8)**  
**International Baccalaureate**  
[anwatin.mpls.k12.mn.us](http://anwatin.mpls.k12.mn.us)  
Visit the school website to sign up for a tour or call 612-668-2450 for more information.



# Events and Activities at Sumner Library

**Sumner Library**  
611 Van White Memorial Blvd.  
Minneapolis, MN 55411  
Register at [www.hclib.org](http://www.hclib.org)

## FOR ADULTS:

**Having Difficult Conversations with Family: Where to Start - Wednesday, April 28, 2021, 7:00-8:30pm**  
Brenison Wheeler from Women’s Advocates will lead a discussion on the following topics: What are the different kinds of difficult conversations and why should we have them? How do we address the barriers to having difficult conversations with family? How do we increase our tolerance for disagreement and value learning from each other? How do I actually have these difficult conversations? How do I even bring them up? How can I set boundaries and protect my energy in the process? *This event is a part of the Empowering You series.*

**Great Decisions: Brexit and the European Union – Monday, April 5, 4:00-5:30pm**  
Macalester College Professor Andrew Latham will speak on the 2021 Great Decisions topic, “Brexit and the European Union,” in light of the global pandemic and the dramatic fluctuation in the economic forecasts. Sponsors: Friends of the Edina, Plymouth and Washburn libraries, Edina Senior Center, Minneapolis Community Education. The link to the live online discussion will be emailed to registrants in advance.

**Meditation for Modern Life – Mondays, April 5, 12, 19 and 26, 11:30am-12:00pm**  
The ancient tradition of meditation has become even more valuable for people of today who face a great deal of turmoil in their private lives and in the world. Meditation is a tool that can be used to cope with the challenges of everyday life and reduce stress. There are many benefits that come from meditation on a physical, emotional, and spiritual level. Join Nirav Sheth, long-time meditator, who will teach you a simple time-tested meditation technique, and even have the chance to try it!  
The link and phone number for the live online discussion will be emailed to registrants in advance.

**Author Talk with Anthony Scott: Minnesota’s Black Community in the 21st Century – Wednesday, April 21, 1:00-2:00pm**  
Join us for the second in a series of authors talk with Anthony R. Scott, contributing author of The Scott Collection and the new book Minnesota’s Black Community in the 21st Century which recently won the R.

Wayne Pace Human Resource Development book of the year award. This is a monthly discussion with this month’s guests; Reese Dyer, Shirlee Callender and Rose MaGee who will discuss their work experiences, community connections and other ventures.  
Minnesota’s Black Community in the 21st Century shines a spotlight on African American individuals and organizations who are helping to build a better Minnesota. Continuing the tradition established by the pioneering books published by Walter R. Scott Sr. in the 1950s, ’60s, and ’70s, the Minnesota Black Community Project highlights the contributions of contemporary black Minnesotans in the fields of the arts, beauty and fashion, community service, education, entertainment, finance, government, labor, law and law enforcement, media and communications, medicine and health care, religion, social services, sports, science and technology, and more. Through a collaborative effort of writers and photographers, the book profiles men, women, and youth from throughout the state and examines the myriad ways in which the black community is engaged in Minnesota politics, business, and culture. Providing a snapshot look at African Americans today, the book offers inspiration for the future and looks forward to where we are heading. This program is presented in partnership with the Sabathani Senior Center and sponsored by the Friends of Hennepin County Library.  
**Great Decisions: Brexit and the European Union – Monday, April 5, 4:00-5:30pm**  
Macalester College Professor Andrew Latham will speak on the 2021 Great Decisions topic, “Brexit and the European Union,” in light of the global pandemic and the dramatic fluctuation in the economic forecasts. Sponsors: Friends of the Edina, Plymouth and Washburn libraries, Edina Senior Center, Minneapolis Community Education. The link to the live online discussion will be emailed to registrants in advance.

**FOR KIDS:**  
**Live Virtual Play and Learn with Minneapolis Public Schools ECFE – days of the week and times vary.**  
**Search [www.hclib.org/events](http://www.hclib.org/events)**  
Enjoy songs and books geared towards children birth-5 years old. Join at any time during the hour! Hosted by Minneapolis Public Schools ECFE in partnership with Hennepin County Library.  
Sessions held on Google Meets. Link provided in event listing on library website.



# Youth & Schools

Lynda Shabeen, BMNA Schools Committee Chair

## Community Education Spring Class Brochure

This spring Minneapolis Community Education has 350+ virtual and in-person enrichment classes for community connection, growth and learning. With diverse online programs curated for youth, adults, families, people ages 55+, and adults with developmental disabilities, we have something for everyone. To check out all our classes, go to our virtual brochure. You can register at [mplscommunityed.com](http://mplscommunityed.com). For questions and help with registrations please contact [laura.campbell@mpls.k12.mn.us](mailto:laura.campbell@mpls.k12.mn.us) or 612-668-1162

## Four Bryn Mawr Youth qualified for State High School Downhill and Nordic Ski events in March

**Victor Sparks**, Southwest High School Senior of Area 1, finished 2nd in the classic race, 9th in the skate race, 6th overall. Victor is also Captain of the Southwest Nordic Ski team that won the state title. Victor also won a state title with Southwest as an 8th grader and this was his 5th state meet. Victor will be heading to Colby College in Waterville, Maine. Victor will be a member of their nationally ranked Nordic ski team. Olympia Sparks, Southwest High Freshman placed 47th in the classic race, 32nd in skate for 42nd overall. Olivia was skiing in her first state meet. Victor and Olivia moved to Bryn Mawr when Victor was nine and Olympia was six. Both started skiing at Theodore Wirth shortly after we moved and have been skiing ever since!  
Area 4 resident **Olivia Etz**, a Senior at St. Louis Park High School, traveled to Giants Ridge for the State Nordic championship. Olivia got her start as a competitive skier at the age of 5 when she participated in the Minni-Loppet as a Bryn Mawr Elementary kindergartner.

## Contact Information For Bryn Mawr Community Schools

**Bryn Mawr Elementary (PreK-5)**  
252 Upton Avenue South  
612-668-2500  
[brynmawr.mpls.k12.mn.us](http://brynmawr.mpls.k12.mn.us)  
**Minneapolis Kids School-age Childcare (at Bryn Mawr School)**  
612-668-3890  
[mplskids.mpls.k12.mn.us/](http://mplskids.mpls.k12.mn.us/)  
**Anwatin Middle School (6-8)**  
**International Baccalaureate**  
256 Upton Avenue South  
612-668-2450  
[anwatin.mpls.k12.mn.us](http://anwatin.mpls.k12.mn.us)  
**Anwatin Community Education**  
612-668-2478  
[www.mplscommunityed.com](http://www.mplscommunityed.com)

She has taken full advantage of our close proximity to Wirth Park for her training by running or skiing on the trails almost every day. After graduation Olivia plans to study architecture “somewhere in the snow belt”.  
**Meghan Abel**, a senior at Southwest High School and resident of Area 2 and 5, is Captain of the Minneapolis Alpine Ski Team (MAST). Meghan led her team to sectionals where they placed 2nd as a team and Meghan qualified as an individual participant for the state meet. She skied two clean runs at state and placed 51st out of 90 top state racers. There were 7 total state participants from the MAST team. This is her third year in a row going to state with her team, but first time qualifying as an individual. Meghan started Alpine skiing when she was five, skiing out west with family and enrolled in Ski Jammers instruction program with other Bryn Mawr skiers continuing to fine tune her skill. Meghan started alpine skiing for Southwest High School when she was in 7th grade while attending Anwatin Middle School and has enjoyed learning how to negotiate the Slalom Course. Meghan plans to attend college next year but hasn’t decided where yet.

FREE School Meal Boxes  
for ALL youth!

Find out more at [cws.mpls.k12.mn.us](http://cws.mpls.k12.mn.us)

DWI  
CRIMINAL DEFENSE

24 HOUR HELP

• TESTING ADVICE • BAIL • JAIL RELEASE •

• DETOX RELEASE  
• DRUGS

OVER 30 YEARS  
EXPERIENCE

SUPER LAWYER  
2006 through 2016

FREE INITIAL CONSULTATION

612-341-9080

GERALD MILLER, P.A.  
LAWYER



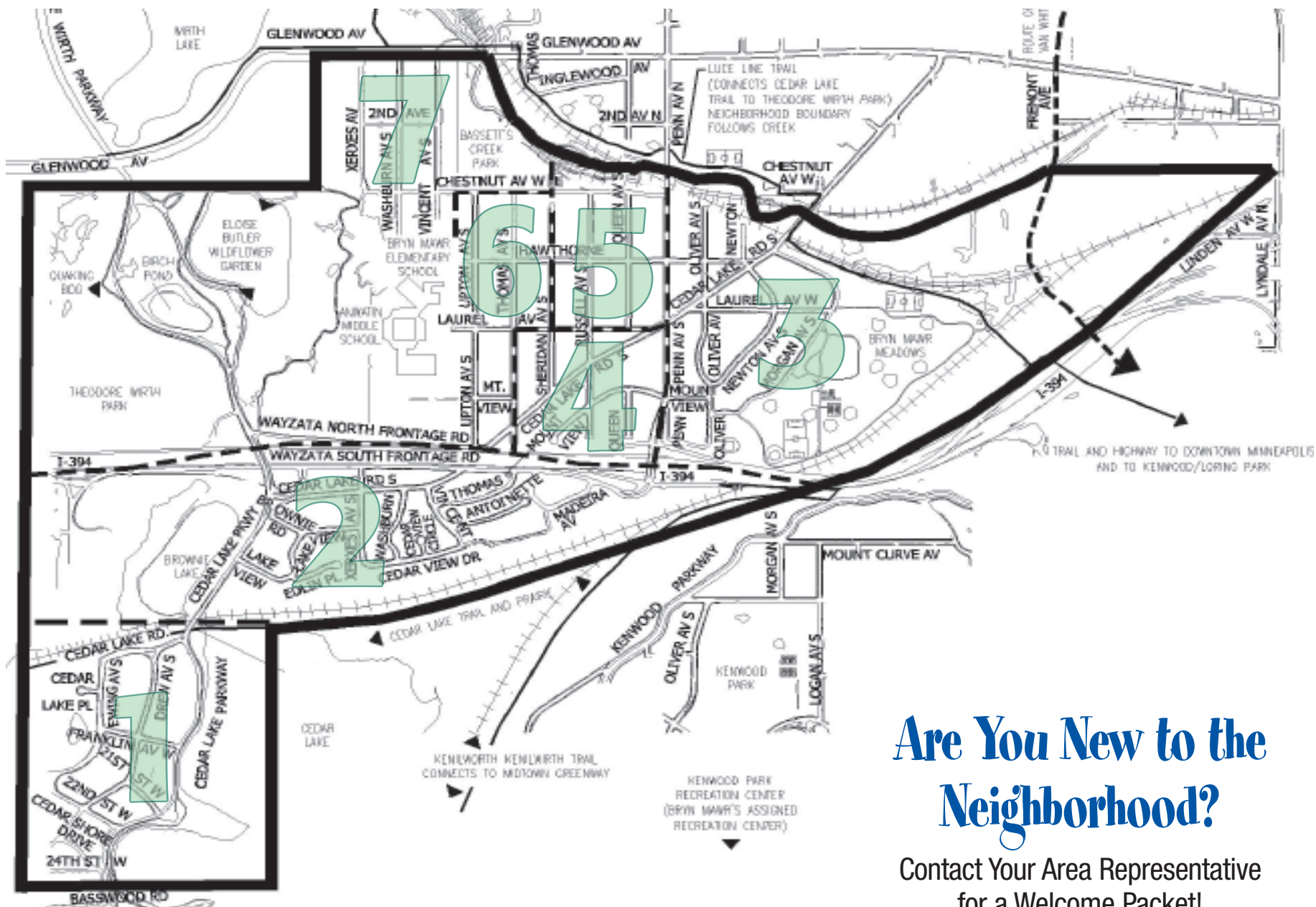

# Are You New to the Neighborhood?

Contact Your Area Representative for a Welcome Packet!

## THE BRYN MAWR NEIGHBORHOOD ASSOCIATION

2915 Wayzata Boulevard, Minneapolis, MN 55405  
612-234-7819 • [bmna@bmna.org](mailto:bmna@bmna.org) • [www.bmna.org](http://www.bmna.org)

### BMNA Board Members

**President:**  
Kevin Thompson, [president@bmna.org](mailto:president@bmna.org) 612.296.5409

**Vice President:**  
Brian Treece, [vicepresident@bmna.org](mailto:vicepresident@bmna.org) 763.229.3663

**Treasurer:**  
JD Dietrich, [treasurer@bmna.org](mailto:treasurer@bmna.org) 612.306.9593

**Secretary:**  
Jessica Wiley, [secretary@bmna.org](mailto:secretary@bmna.org) 612.374.3481

### Area Representatives

1 Liv Nielsen [liv.nielsen@bmna.org](mailto:liv.nielsen@bmna.org) 612.719.9734

2 Karen Frederickson [karen.frederickson@bmna.org](mailto:karen.frederickson@bmna.org) 612.558.1910  
Susan Verrett [susan.verrett@bmna.org](mailto:susan.verrett@bmna.org) 612.377.7447

3 Allison Fruen [allison.fruen@bmna.org](mailto:allison.fruen@bmna.org) 612.708.2135  
Dennie Juillerat [dennie.juillerat@bmna.org](mailto:dennie.juillerat@bmna.org) 612.850.5658

4 Christopher Etz [christopher.etz@bmna.org](mailto:christopher.etz@bmna.org) 612.378.2987  
Joanne Michalec [joanne.michalec@bmna.org](mailto:joanne.michalec@bmna.org) 612.377.3348

5 Colleen Dhennin [colleen.dhennin@bmna.org](mailto:colleen.dhennin@bmna.org) 763.639.1868  
Beth Turnbull [beth.turnbull@bmna.org](mailto:beth.turnbull@bmna.org) 612.423.3033

6 Rod Miller [rod.miller@bmna.org](mailto:rod.miller@bmna.org) 612.377.9235  
Jay Peterson [jay.peterson@bmna.org](mailto:jay.peterson@bmna.org) 612.377.4677  
Barry Schade [barry.schade@bmna.org](mailto:barry.schade@bmna.org) 612.203.1758

7 Steve Harvey [steve.harvey@bmna.org](mailto:steve.harvey@bmna.org) 612.374.3613  
Kate Knuth [kate.knuth@bmna.org](mailto:kate.knuth@bmna.org) 651.308.9921  
Anthony Ramirez [anthony.ramirez@bmna.org](mailto:anthony.ramirez@bmna.org) 612.516.2177

Board Member Emeritus: Vida Ditter 612.374.1481

The Bryn Mawr Bugle is an open-forum newspaper published by the Bryn Mawr Neighborhood Association. Content is based entirely on volunteer submissions which may be emailed to [bugle@bmna.org](mailto:bugle@bmna.org). Articles and letters to the editor will be printed at the discretion of the Editor. The Bryn Mawr Bugle is published every month except January. Distribution is free to Bryn Mawr residents; copies are also available at the Bryn Mawr Market, Bryn Mawr Mobil and Cuppa Java. Subscriptions are \$21 per year. Opinion articles represent the opinion of the writer; not necessarily those of the Bryn Mawr Neighborhood Association or the Editor of the Bugle. The Bryn Mawr Bugle will print letters to the editor as space allows. Letters may be edited for length without altering the letter writer's message. Letters must be signed by the person who wrote them. Under the law, letter writers, like journalists, may not commit libel, be obscene, reveal names of juveniles accused of crime, invade personal space, or incite to riot.

**Copy deadline for the May issue is April 20, 2021.**

Display & Classified Ads are due April 20th. Ads must be pre-paid & camera ready.

Call Deryck Jolstad at (612) 377-8968 or [djolstad@msn.com](mailto:djolstad@msn.com) for rates.

**GENERAL ADVERTISING POLICIES:** All adx copy is subject to approval by the paper, which reserves the right to reject or request changes to an ad. Ad placement does not imply endorsement by the BMNA. The advertiser, not the paper, is responsible for the truthful content of the ad. Readers use service/product providers at their own risk and are solely responsible for checking references, state agencies, BBB, etc.



## Want Ads

**Rates:** \$4.50 minimum (4 lines, approx. 40 characters per line), \$.50 per additional line. FREE ads for lost, found, free items, pets & youth ads.  
**Due Date:** 20th of preceding month. **Instructions:** No ads over the phone please or accepted without payment. Drop off in the Bugle Box at the Bryn Mawr Market or email [bugle@bmna.org](mailto:bugle@bmna.org).

Be sure to check references, State Agencies, BBB, etc. and inquire about bonding when using any new service.

### SERVICES

**CONCRETE/BRICK/STONE/MASONRY:** Repair or New - foundations, driveways, sidewalks & steps, garage slabs, also kitchens & bathrooms. Call Gary 651-423-6666.

**SNOW REMOVAL, TREE & SHRUB TRIMMING:** Premier Lawn & Snow, Inc. providing reliable snow removal, lawn care, tree and shrub trimming with quality results for SW Minneapolis since 1987. For prompt estimate call Dennis (952) 545-8055.

### WANTED

**Looking for historical photos,** documents, stories, illustrations, etc. pertaining to Cedar Lake's west side for personal research. I am an Area 1 resident and while my interest is broad, I am particularly focussed on anything that pertains to West 21st Street. email: [roger@remvideoevent.com](mailto:roger@remvideoevent.com) with 'Cedar Lake' in the subject line.

### YOUTH

**LOOKING FOR A PET SITTER?** I can help! I have previous experience fostering dogs and have 2 dogs myself. I love all animals and would be happy to care for them. Whether it's feeding your hamsters while you're away, taking your dog(s) on a walk, playing with the cats... I can do it. You can email me at [emilymw2004@gmail.com](mailto:emilymw2004@gmail.com) if you'd like me to clarify anything or figure out the details :)

**Smith Sisters Sitters:** Gentle and Fun Baby Sitters in the Bryn Mawr Neighborhood Two responsible teenage sisters who enjoy kids and know how to deal with everything from diapers to dinner. Can work together for large families, or one-on-one for maximum flexibility to fit your schedule. Contact us at the email below to schedule your night out.  
[SmithSisterSitters@Outlook.com](mailto:SmithSisterSitters@Outlook.com) Starting at \$8 / hour

## COORDINATOR CORNER

### Communications and Fundraising Coordinator

Lynda Shaheen

612-234-7819 • [coordinator@bmna.org](mailto:coordinator@bmna.org)

If you are not part of our e-mail list, please sign up at [www.bmna.org](http://www.bmna.org).

## Bugle also available at [www.bmna.org](http://www.bmna.org)

A reminder that in addition to being delivered to your doorstep, the Bryn Mawr Bugle is available online at [bmna.org](http://bmna.org). Click on the Bugle logo on the home page to read the current edition or go under the 'Bugle' tab to see past editions and to learn more about advertising rates and submission deadlines.